

**COPPER TUBULAR END SEALING
FERRULES FOR SOLDERLESS
CRIMPLING TO COPPER OR
ALUMINIUM CONDUCTORS(AS PER
DIN-46228)**

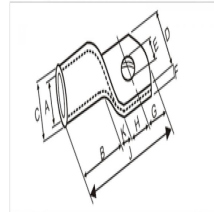

| Size | Cat(AEH) | Price |
|------|----------|-------|
| 0.05 | 508 | 0.55 |
| 0.75 | 509 | 0.49 |
| 1.0 | 510 | 0.55 |
| 1.0 | 511 | 0.75 |
| 1.5 | 512 | 0.62 |
| 1.5 | 513 | 0.75 |
| 2.5 | 514 | 0.70 |
| 2.5 | 515 | 0.99 |
| 4 | 516 | 0.81 |
| 4 | 517 | 0.99 |
| 6 | 518 | 0.86 |
| 6 | 519 | 0.99 |
| 6 | 520 | 1.18 |
| 10 | 521 | 1.15 |
| 10 | 522 | 1.38 |
| 10 | 523 | 1.64 |
| 16 | 524 | 1.60 |
| 16 | 525 | 1.68 |
| 16 | 526 | 1.99 |